

HEATED ASPHALT DISTRIBUTOR

Operating Instructions & Parts Manual



SealMaster[®]

Pavement Products & Equipment

PO Box 2277 • Sandusky, Ohio 44870 • 419-626-4375

SealMaster[®]

CALIFORNIA

Proposition 65 Warning

Diesel engine exhaust and some of its constituents are known to the State of California to cause cancer, birth defects, and other reproductive harm.

ThorWorks Industries, Inc.

Purchased by _____ Model NO. _____
Company Name _____ Serial NO. _____
Address _____ Acceptance Date _____
City _____ State _____ Zip _____

CORRESPONDENCE

All Correspondance regarding this equipment, as well as general correspondence should be addressed to:

ThorWorks Industries, Inc.
PO Box 2277
Sandusky, OH 44870

In referring to the equipment, kindly state the Model Number, Serial Number and any part number involved



SealMaster Limited Warranty

SealMaster warrants that its products are of quality material and workmanship. SealMaster agrees to replace, within a period of one (1) year from date of delivery, or at its option, repair, without charge, any part of their manufacture which proved defective. The repair or replacement will be free of charge F.O.B Sandusky, Ohio, proving the damaged part or parts are returned, freight prepaid, to SealMaster and investigation show such repair or replacement is made necessary by inherent defect of material or workmanship.

It is hereby understood that engines, motors, pumps, or other components purchased by SealMaster for use on its equipment are not warranted by SealMaster and are sold only with the standard warranty of the manufacturer of that component.

SealMaster will make no allowances for repairs or alterations completed by outside sources unless authorization is in writing and approved by an authorized SealMaster representative.

Any claims for defective material or workmanship must be made prior to the expiration of thirty (30) days from the date failure occurs, and in all cases prior to the expiration of the warranty period of one (1) year. It is the intent of this paragraph to limit SealMaster's liability solely to the cost of replacement parts, F.O.B. factory, or at the option of SealMaster to repair of the defective part or parts. No allowances for damages, lost time, or any other claim will be recognized.

This warranty is null and void if other than genuine SealMaster parts are used.

SealMaster is constantly striving to improve their products. Changes in design and improvement will be made whenever the manufacturer believes the efficiency of the product will be improved, without incurring any obligation to incorporate such improvements in any machines which have been shipped or are in service.

In an effort to continue to improve product quality, SealMaster reserves the right to change specifications without notice.

Any modification or alteration of this machine without prior approval of the manufacturer may void this warranty.

CAUTION

THE OPERATOR MUST BE AWARE THAT HE IS WORKING WITH A MECHANICAL DEVICE THAT CONTAINS HOT MATERIALS

AND MUST WEAR APPROPRIATE PROTECTION AND EXERCISE CAUTION AT ALL TIMES.

**ALL EMPLOYEES SHOULD BE TRAINED IN EMERGENCY BURN
FIRST AID**

**NEVER OPERATE UNIT WITHOUT EYE PROTECTION AND LONG SLEEVE
SHIRTS,AND GLOVES**

**KNOW THE PROCEDURES FOR SAFE OPERATION OF PROPANE FIRED
DEVICES**

**READ AND UNDERSTAND THE MSDS SHEETS FOR THE MATERIAL YOU
ARE APPLYING**

DO NOT BREATHE THE FUMES FROM THE MATERIAL BEING HEATED

DO NOT OPERATE THE MACHINE IN THE RAIN

NEVER EXPOSE MATERIAL TO AN OPEN FLAME

DO NOT WORK ON MACHINE WHILE IN OPERATION

DO NOT REFUEL ENGINE WHILE BURNER IS LIT

OPERATING INSTRUCTIONS FOR HEATED TACK TANKS

HEATING THE MATERIAL

A. Attach the threaded tank connector # 1 to your LP Gas tank. Note: the burner uses vapor propane, not liquid.

B. Slowly open the valve on the LP Gas tank. Opening too fast can cause a check valve to slam closed reducing the available flow of gas.

C. Regulator # 3 is pre-set for 30 psi. Turn the knob counter clockwise to lower the pressure if you so desire. The burner # 11, is rated for maximum heat output at 30 psi. Open valve # 7 slightly, depress the red push button on gas valve # 8. This allows gas to flow thru the burner, at the same time push in the igniter button # 10 to produce a spark. Push repeatedly until the gas ignites.

If the gas does not light within 5 seconds, release the red push button and wait 10 minutes before trying again.

D. Once you have ignition, you must continue to depress the red push button # 8 for at least 10 seconds. This allows the thermocouple # 9 to heat up, which sends a signal to the gas valve to continue to allow the gas to flow. If the flame stays on, then open valve # 7 all of the way to get maximum heat from the burner. If the flame goes out, you will need to start over with the lighting process.

Anytime you want to decrease the flame intensity, slightly close this valve.

E. The thermocouple # 9, also acts as a safety. Should the flame go out because of wind, the thermocouple immediately starts to cool off and stops the signal to the gas valve, which then stops the flow of gas. This may take up to 30 seconds. **WAIT 10 MINUTES BEFORE TRYING TO RE-LIGHT THE BURNER.**

F. Monitor material temperature on thermometer # 13. As the material reaches the desired temperature you can slightly close valve # 7 to decrease the flame. Or just shut off the valve completely. When finished for the day, close the valve on the LP Gas tank and valve # 7.

NEVER DRIVE WITH THE BURNER LIT !!

PUMPING MATERIAL

A. Open valves # 16 and # 24. Close all other valves.

B. Start the engine, # 23 only after reading the engine manual provided with your machine. Engine speed will determine the gallons per minute pumped.

C. The pump, # 22 is drawing material from the tank, thru the basket strainer # 17, and is sent thru valve # 24 and into the top of the tank. This is called recirculation.

D. Uncoil the spray hose from the side hangars on the tank. Open valves # 25 and 27. Slowly start to close valve # 24. This will send some product down the spray hose and out the wand tip # 28. Partially closing this valve allows you to adjust the desired spray pressure. **NEVER CLOSE VALVE # 24 COMPLETELY!!**

E. When using the spraybar # 31, valves # 25 and 27 remain closed. Open valve # 38. Once you have recirculated product, slowly close valve # 24 and swing the large lever on the spraybar to the open position. You may want to start the machine in motion before doing this to prevent having excess material at your starting point. Once again, valve # 24 determines spray pressure, adjust accordingly.

F. When finished, close all valves.

DIESEL FLUSH

A. Close valves # 16 and 24. Start the engine # 23.

B. Open valve # 15 on the bottom of the diesel tank # 12.

C. Open valves # 25 and 27 to flush the spray hose and wand. To flush the spraybar open valve # 38. Swing the lever on the spraybar # 31 to the open position. When done turn off the engine and close all open valves.

D. Remove the lid from the basket strainer # 17 and clean the basket.

Note: anytime you notice the spray pressure is decreasing, the basket probably needs to be cleaned. Make sure you close valve # 16 anytime you remove the lid.

MAINTENANCE TIPS

A. Adjust belt tension by going halfway between the center of the two pulleys and moving the belt up and down. It should move about ½”.

B. Clean the strainer basket daily.

C. Use only water or diesel fuel for flushing purposes.

D. The material pump has a mechanical seal, some leakage is normal. When the seal plate can not be tightened any more, the seal must be replaced.

E. The orifice on the burner needs to be cleaned occasionally. Soot and spider webs can cause blockage of the flow of gas.

F. Always leave the LP gas hose connected to a tank. If left off, insects will make their nests inside of it and block the flow of gas.

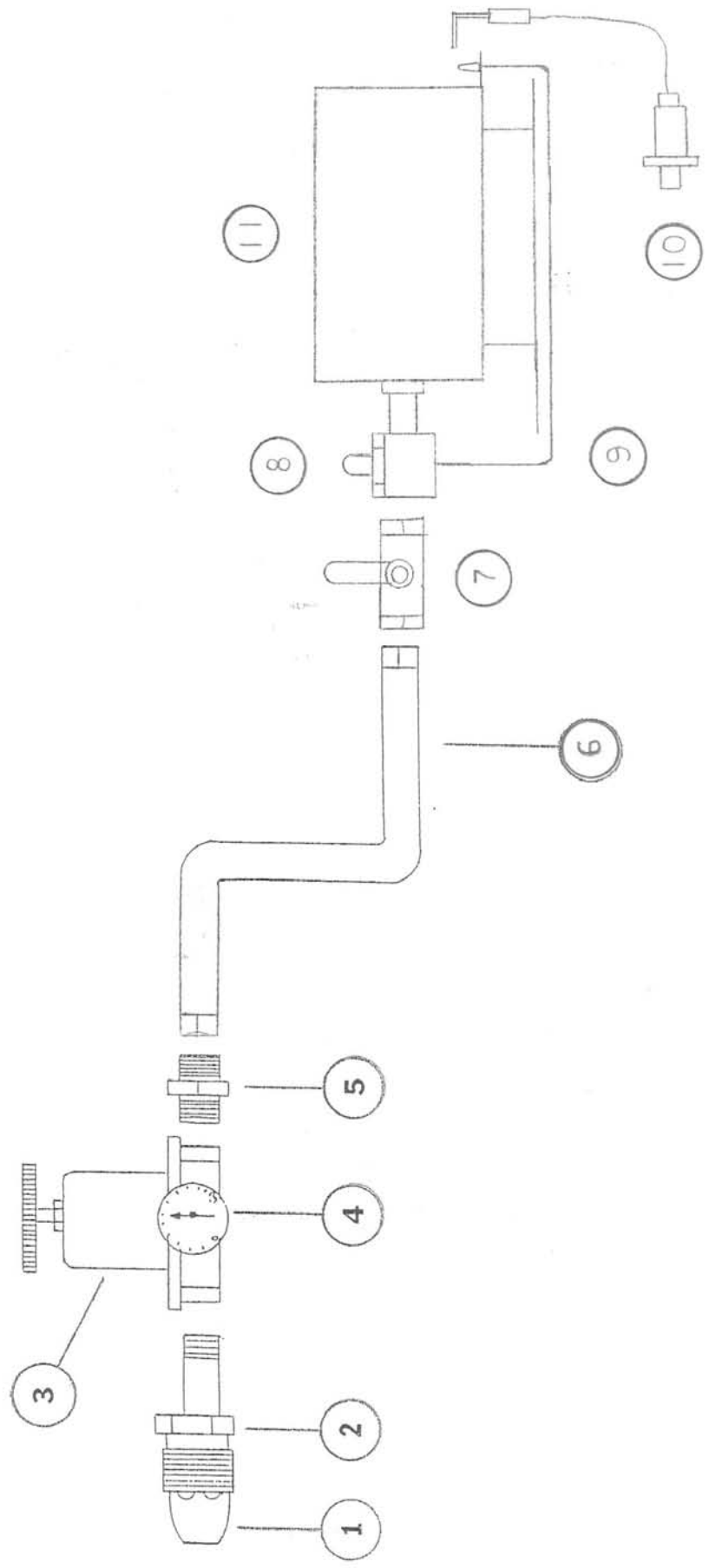

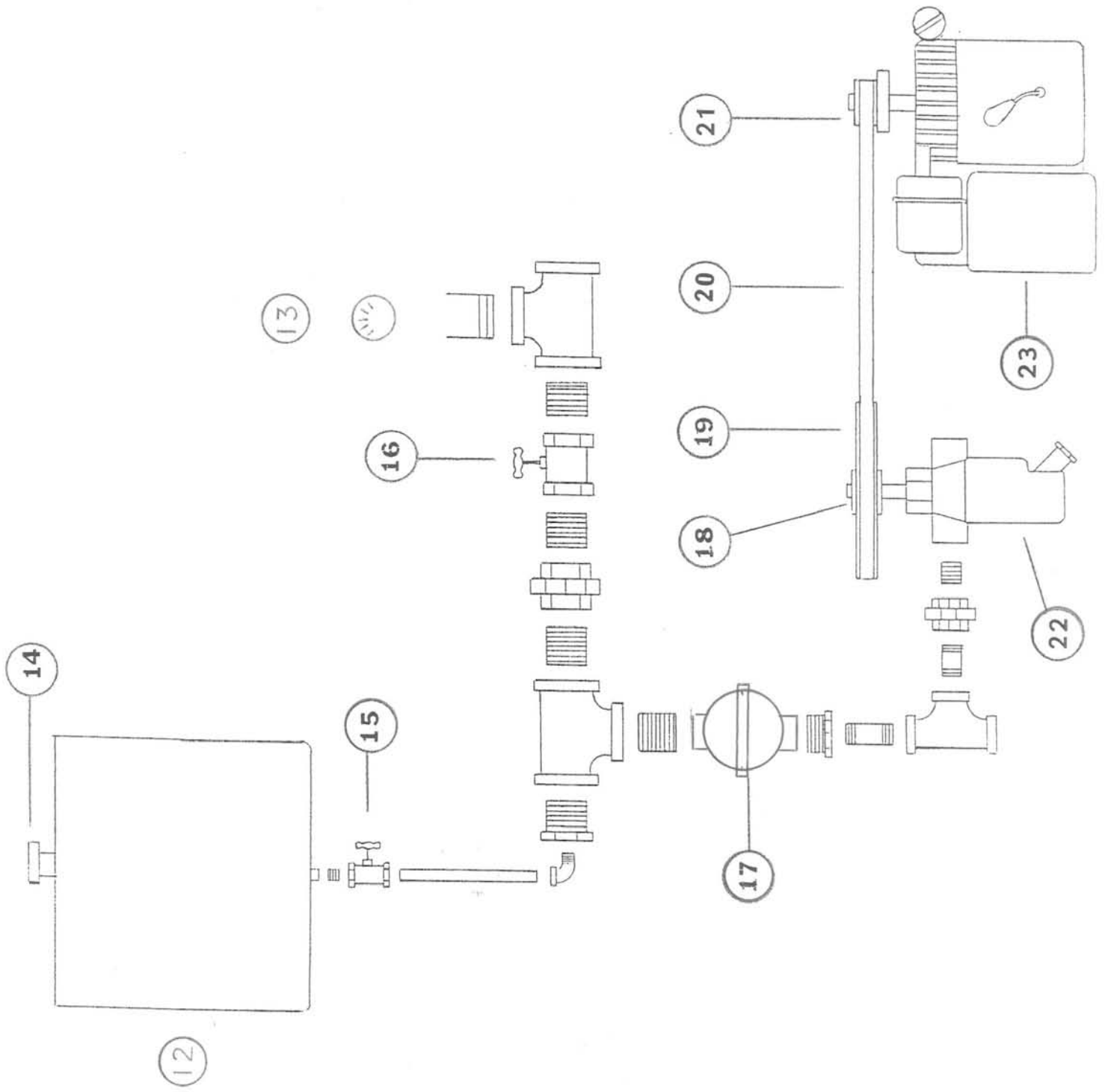

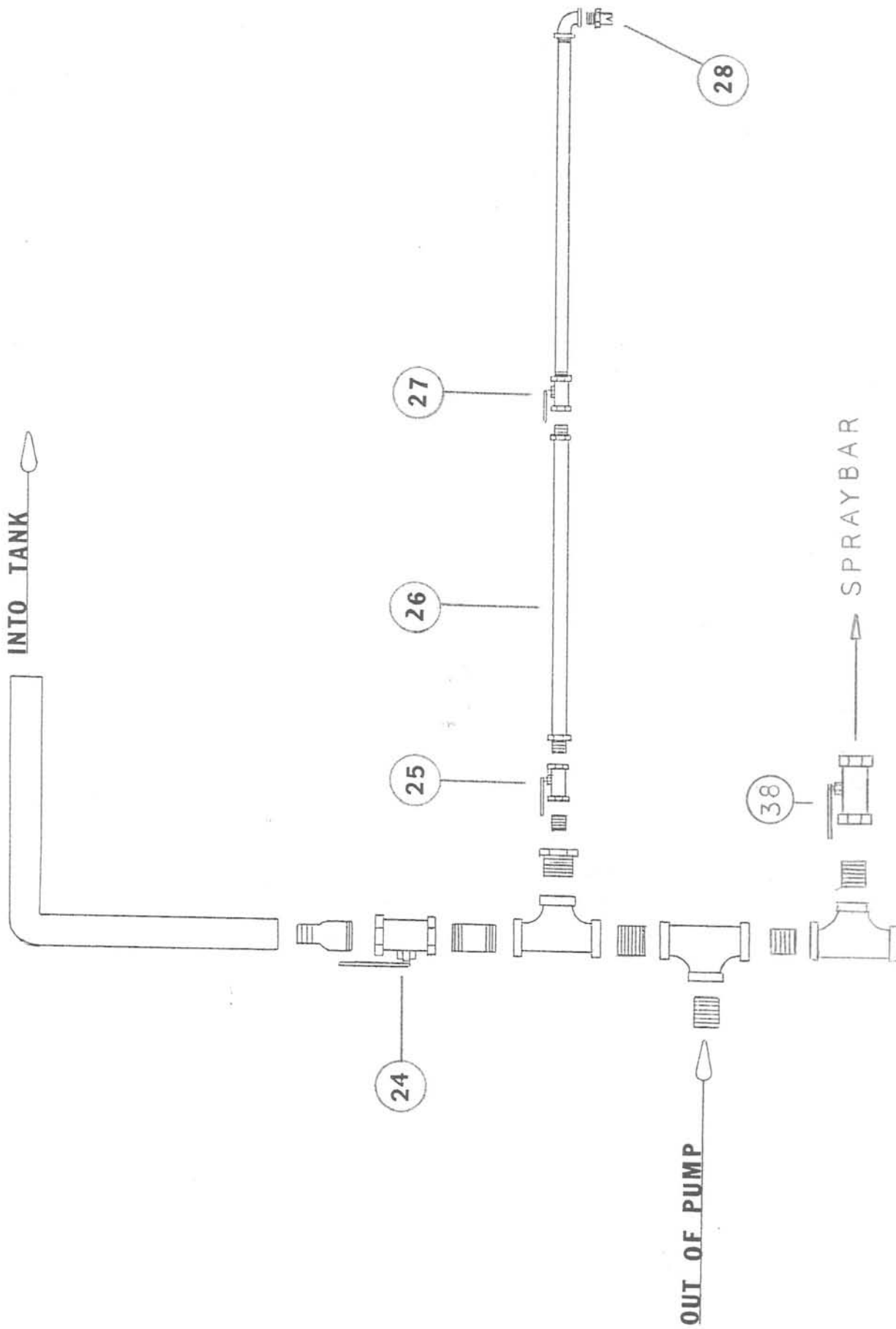

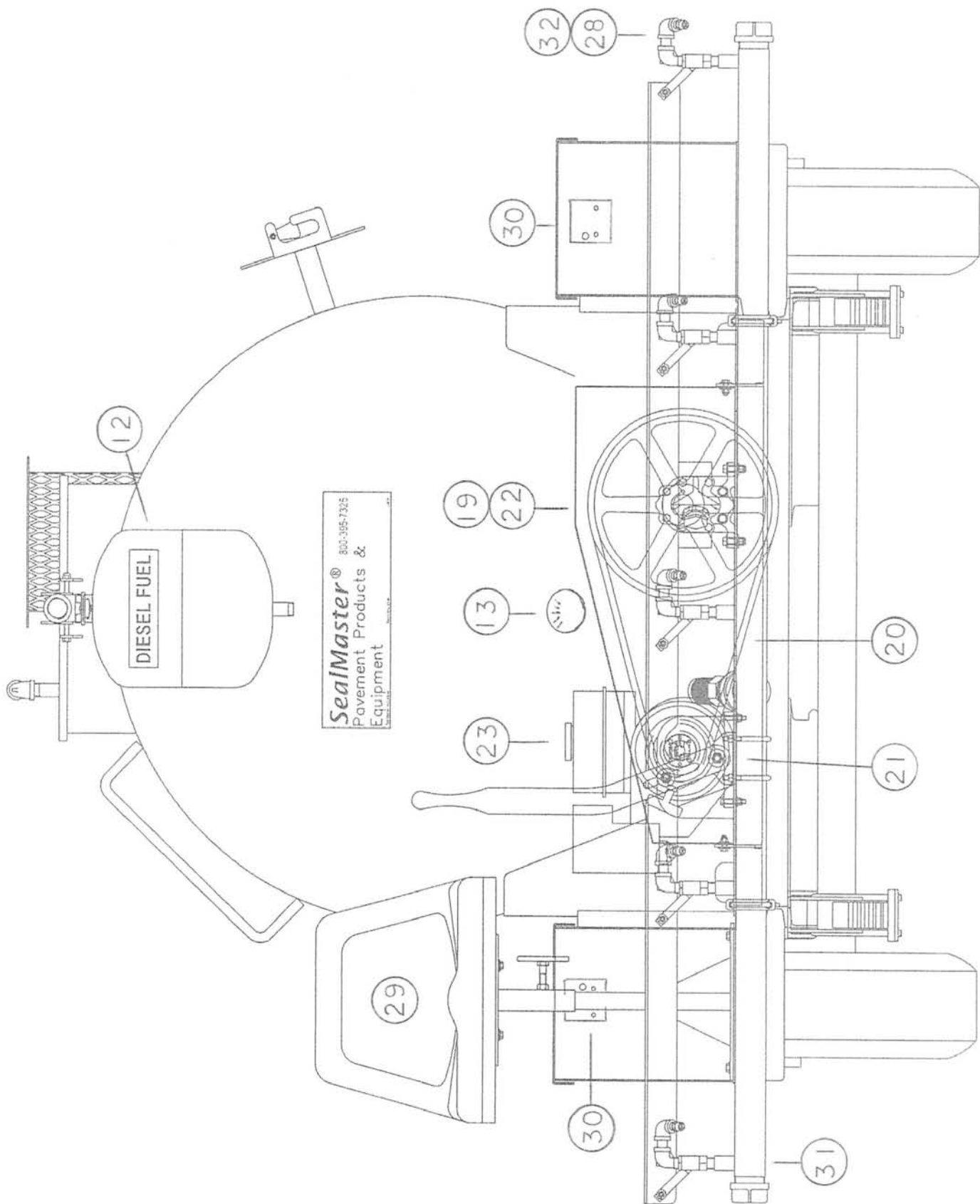

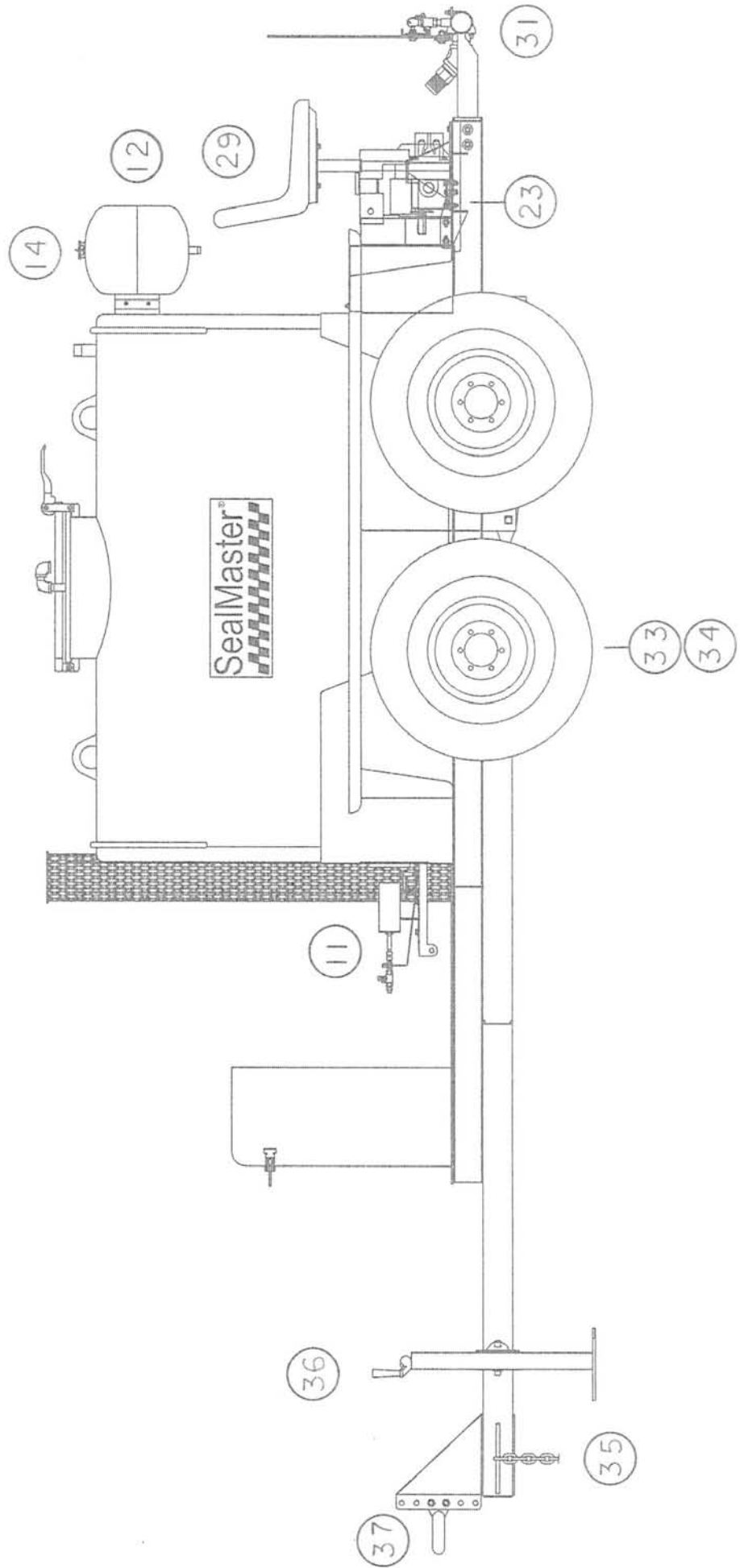

PARTS LIST

REF #	ITEM	PART #	QTY
1	NIPPLE,INLET	P932A001	1
2	PALNUT	P933A001	1
3	REGULATOR	P735A014	1
4	PRESSURE GAUGE	P735A007	1
5	COUPLER	P935A001	2
6	LP GAS HOSE-10 FT.	P669A005	1
7	SHUTOFF VALVE	P397A011	1
8	GAS PILOT VALVE	P735A016	1
9	THERMOCOUPLE	P679A003	1
10	IGNITOR-PUSHBUTTON	P677A002	1
11	BURNER,COMPLETE	P662A003	1
12	FLUSH TANK	P9999	1
13	THERMOMETER	P659A010	1
14	TWIST CAP	P464A002	1
15	BALL VALVE	P397A001	1
16	BALL VALVE	P397A012	1
17	BASKET STRAINER,COMPLETE	P50147B004	1
	STRAINER BASKET	P50313B	1
18	BUSHING	P740A006	1
19	SHEAVE	P661A033	1
20	V-BELT	P660A016	1
21	SHEAVE	P661A034	1
22	MATERIAL PUMP	P640A029	1
23	ENGINE	P458A022	1
	OPTIONAL DIESEL ENGINE	P458A034	1
24	BALL VALVE	P397A012	1
25	BALL VALVE	P397A001	1
26	SPRAY HOSE	P754B025	1
27	BALL VALVE	P397A010	1
	SPRAY WAND,COMPLETE	P50273B	1
28	SPRAY TIP	P449A011	6
29	SEAT	P602A003	1
30	TAIL LIGHT,LEFT	P516A016	1
	TAIL LIGHT,RIGHT	P516A017	1
31	SPRAYBAR,COMPLETE	P50246AW	1
32	BALL VALVE	P397A009	5
33	AXLE	P511A013	2
34	WHEEL ASSEMBLY	P514A022	4
35	BREAK-A-WAY KIT	P518A004	1
36	TRAILER JACK	P551A001	1
37	PINTLE EYE COUPLER	P646A003	1
	2 5/16" BALL HITCH	P553A008	1
38	BALL VALVE	P397A012	1

ROPER PUMP

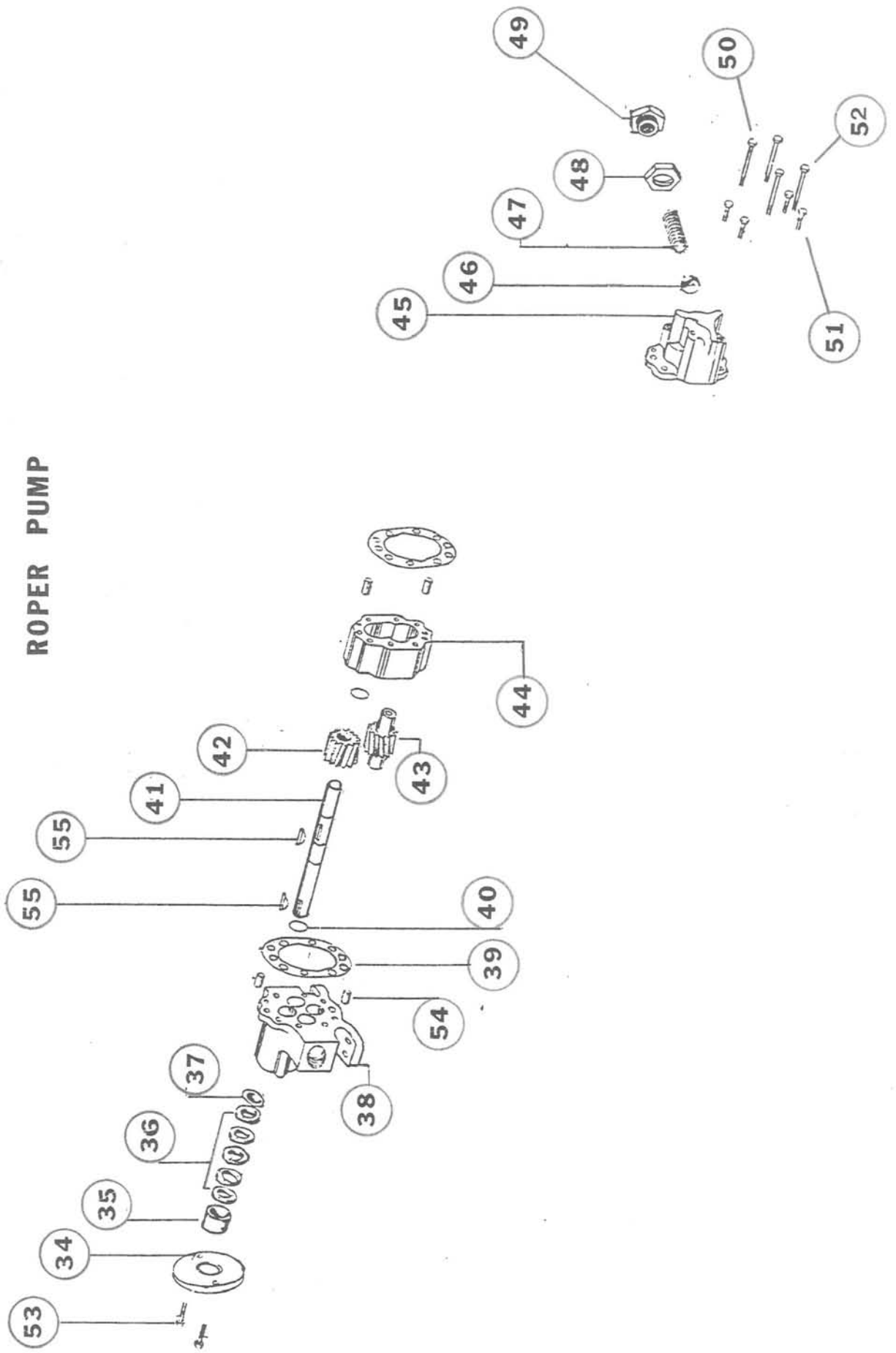

<u>ITEM</u>	<u>PART #</u>	<u>DESCRIPTION</u>
34.	899A001	Packing Plate
35.	899A002	Packing Bushing
36.	899A003	Packing Set
37.	899A004	Packing Washer
38.	899A005	Back Plate Assembly
39.	899A006	Gaskets
40.	899A007	Retaining Ring
41.	899A008	Drive Shaft
42.	899A009	Drive Gear
43.	899A010	Idler Gear and Shaft
44.	899A013	Case
45.	899A014	Face Plate Assembly
46.	899A015	Poppet
47.	899A016	Spring
48.	899A017	Nut, Lock and Seal
49.	899A018	Adjustment Screw
50.	899A019	Hex Head Cap Screw
51.	899A020	Hex Head Cap Screw
52.	899A021	Hex Head Cap Screw
53.	899A022	Hex Head Cap Screw
54.	899A023	Dowel Pin
55.	899A024	Key

MAINTENANCE SCHEDULE-HEATED TACK SPRAYER

	8 HRS	25 HRS	1 WK	MTHLY	1 YEAR
TIGHTEN V-BELT	*		*	*	
REPLACE V-BELT					*
TIGHTEN PUMP PACKING		*		*	
TORQUE WHEEL NUTS	*				*
GREASE WHEEL BEARINGS					*
INSPECT BRAKE LININGS					*
REPLACE SPRAY HOSE					*
REPLACE BURNER THERMOCOUPLE					*
CLEAN BURNER ORFICE					*
CLEAN OUTSIDE OF BURNER TUBE					*
CHANGE ENGINE OIL		*		*	
CHECK TIRE AIR	*			*	

TANK CAPACITY CHART

MATERIAL DEPTH IN INCHES	300 GAL 41" X 54"	550 GAL 48" X 74"	750 GAL 56" X 74"	1000 GAL 48" X 132"	1000 GAL 64" X 74"	1500 GAL 64" X 114"	2000 GAL 64" X 144"
	GALLONS	GALLONS	GALLONS	GALLONS	GALLONS	GALLONS	GALLONS
1	3	4	4	7	5	7	9
2	7	10	11	18	11	18	22
3	11	17	18	30	20	30	38
4	17	25	27	45	29	45	57
5	23	34	37	61	40	62	78
6	30	44	48	79	52	80	101
7	37	55	60	98	64	99	125
8	44	66	72	118	78	120	151
9	52	78	85	140	92	141	179
10	60	91	99	162	107	164	207
11	69	103	113	185	122	188	237
12	77	117	128	208	138	212	268
13	86	130	143	232	154	237	300
14	95	144	158	257	171	263	333
15	105	158	174	282	188	290	366
16	114	173	190	308	206	317	401
17	123	187	206	334	224	345	436
18	133	202	223	361	242	373	471
19	142	217	240	388	261	402	508
20	152	232	257	415	280	431	545
21	161	248	275	442	299	461	582
22	171	263	292	469	318	491	620
23	181	278	310	496	338	521	658
24	190	294	327	524	358	551	697
25	199	309	345	551	378	582	735
26	209	324	363	579	398	613	774
27	218	340	381	606	418	644	814
28	227	355	399	633	439	676	853
29	236	370	417	660	459	707	893
30	244	385	435	686	479	739	933
31	252	400	453	713	500	770	973
32	260	414	470	739	520	802	1013
33	268	428	488	764	541	833	1052
34	275	442	506	789	561	865	1092
35	282	456	523	814	582	896	1132
36	289	470	540	838	602	928	1172

MATERIAL DEPTH IN INCHES	300 GAL 41" X 54" GALLONS	550 GAL 48" X 74" GALLONS	750 GAL 56" X 74" GALLONS	1000 GAL 48" X 132" GALLONS	1000 GAL 64" X 74" GALLONS	1500 GAL 64" X 114" GALLONS	2000 GAL 64" X 144" GALLONS
37	295	483	557	861	622	959	1211
38	300	495	574	883	643	990	1250
39	304	507	591	905	663	1021	1289
40	307	519	607	926	682	1051	1328
41	308	530	623	945	702	1082	1366
42		540	639	964	722	1112	1404
43		550	654	981	741	1142	1442
44		559	669	997	760	1171	1479
45		566	683	1010	779	1200	1516
46		573	697	1022	797	1228	1552
47		578	710	1031	816	1256	1587
48		579	723	1033	833	1284	1622
49			735		851	1311	1656
50			746		868	1337	1689
51			757		885	1363	1721
52			766		901	1388	1753
53			775		916	1412	1783
54			782		931	1435	1812
55			787		946	1457	1840
56					960	1478	1867
57					972	1498	1892
58					985	1517	1916
59					996	1534	1938
60					1006	1550	1958
61					1015	1564	1975
62					1023	1575	1990
63					1028	1584	2001
64					1030	1586	2004